

Stepper Motors and Drives

Versatile Drive Interface

Designed with the OEM in mind, the Luminary Series Stepper drive packs a full complement of interface options. Analog velocity and torque control, digital encoder feedback, and digital input and output control points provide flexible design options needed by the OEM.

Stepper Motors with Servo Performance

By using integral encoder feedback, no loss of shaft position under peak torque conditions and quiet operation are true benefits when applied in many environments.

Full Control for Less Cost

This stepper drive and motor combination, when networked with the LMC-400 controller, gains the standard Emerald Motion Language and the EDE software tool kit providing electronic cam motion, electronic gearing and programmable limit switch outputs for synchronized and coordinated motion profiles.

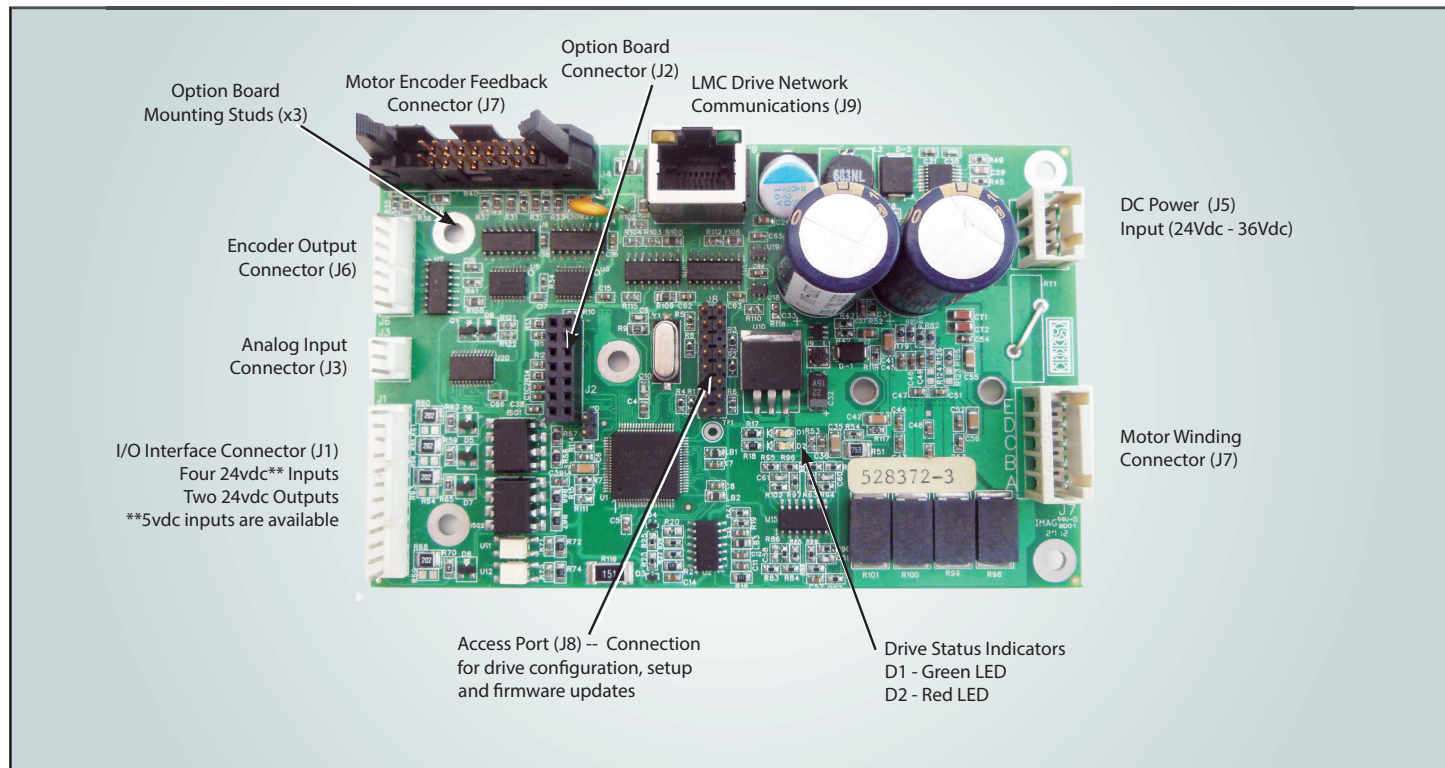

Mechanical Specifications

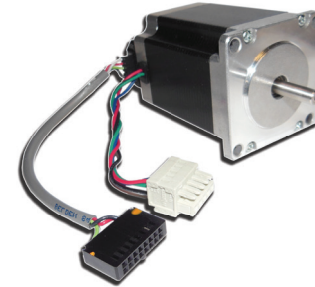
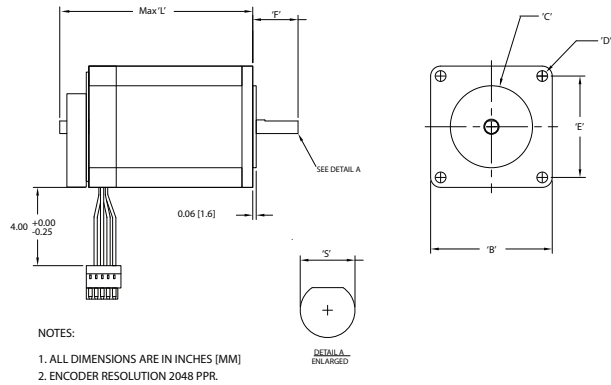

Stepper motor with standard connectors

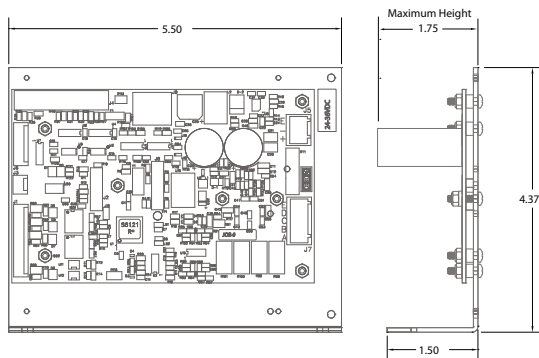

LD-500T drive mounted with the flat plate option

Motor Number	Pilot Diameter C	Bolt Hole E	Shaft Diameter S	Shaft Length F	Body Length L	Frame Size B	Max Temperature	Weight
Scale	mm	mm	mm	mm	mm	mm	C	Kg [lb]
LPM-N17-1R3A030	22	31	5	24	40	42	50°	0.22[]
LPM-N23-2R8A270	38.1	47.1	6.35	21	90	57	50°	1.1[]
LPM-N23-3R0A382	38.1	47.1	6.35	21	90	57	50°	1.1[]

Speed vs. Torque Curves

